

NEW PRODUCT

R53 Series Tied Diaphragm Regulator

The R53 Series Single Stage Tied Diaphragm Regulator consists of a specially designed link between the diaphragm and main valve. It is designed to prevent "creep" if contaminants should form on the valve seat. This feature improves regulator performance and extends the life of the diaphragm. Additionally, a high flow mesh filter is installed before gas enters the seat. It is attached onto the seat. The entire unit can be swapped out during maintenance of the regulator (seat/filter/nozzle).

Debris prior to the seat will be caught by the filter, preventing it from entering the regulator.



Regulator Port Configurations

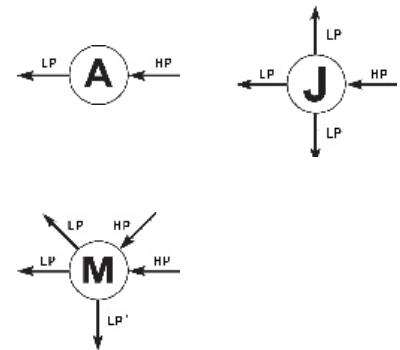

Features

- Single Stage Regulation
- Inlet Port Size: 1/4" NPT(F)

Specifications

- Maximum Inlet Pressure: 3000 psi
- Maximum Outlet Pressure: 250 psi
- Safety Test Pressure: 1.5 x Maximum Inlet Pressure
- Temperature Range: -40 to 165°F (-40 to 74°C)
- Leak Rate: 2×10^{-8} atm.cc/sec He
- Maximum Cv: 0.14
- Weight: 2.0 lb (0.9 kg)

Materials

- Body: 316L
- Seat: PCTFE
- Diaphragm: 316L, Hastelloy®

Applications

- Semiconductor Industry
- Research Laboratories
- Regulation of Specialty Gases
- Gas Chromatography
- Oil & Gas
- Device Manufacturers

Flow Chart

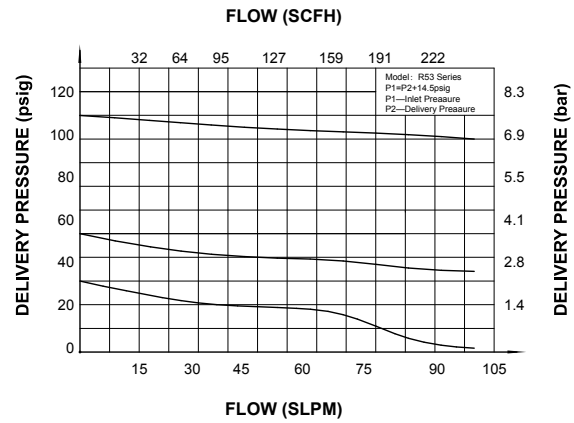
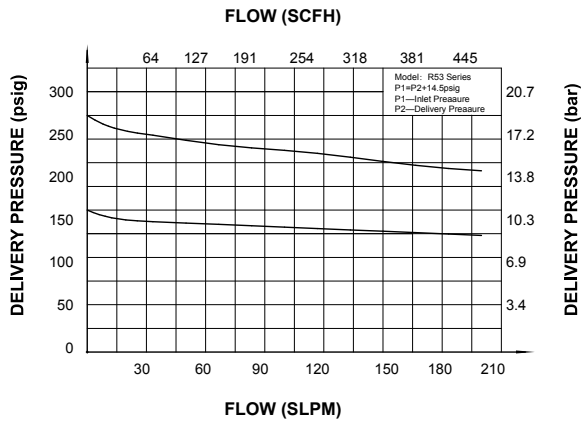

Dimension (mm)

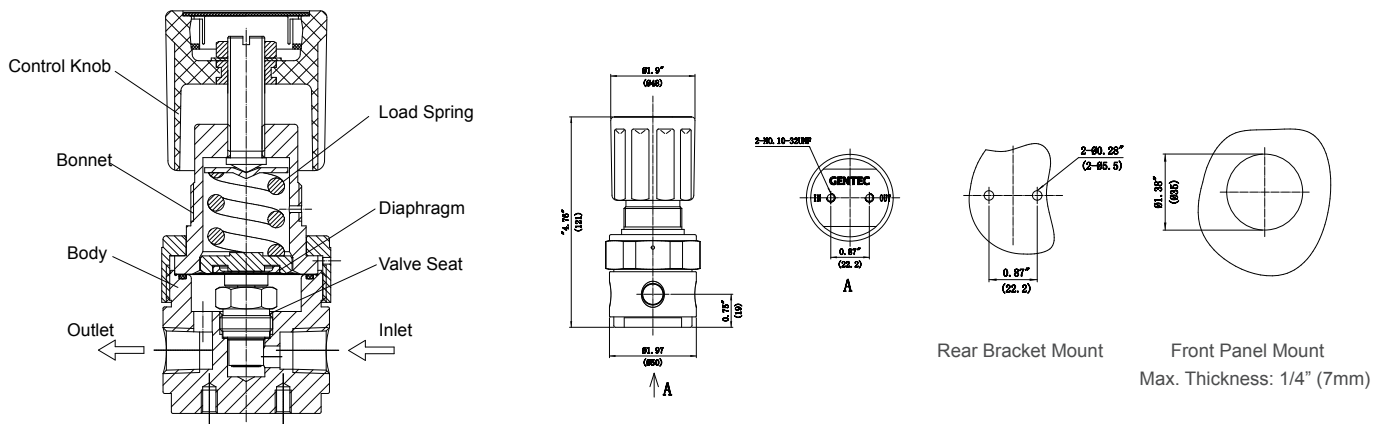

Ordering Information

Ex: R53SL	Q	K	- D	K	P	- 00	- 00	- N
Series	Body Ports	Seat	Inlet Pressure	Outlet Pressure	Gauge	Inlet Connection	Outlet Connection	Options
R53SL (316L)	A J M	K: PCTFE	D: 3000 psi F: 500 psi	G: 0~250 psi I: 0~100 psi K: 0~50 psi L: 0~25 psi Q: 30" Hg Vac~30 psi S: 30" Hg Vac~100 psi T: 30" Hg Vac~200 psi	W: No Gauge K: psi / kPa P: psi / bar G: MPa	00: 1/4" NPT (F) C330: CGA330 C350: CGA350 C580: CGA580 C660: CGA660 C590: CGA590 Other connections available	00: 1/4" NPT (F) 10: 1/8" GENLOK 11: 1/4" GENLOK Other connections available	Blank: None D: Diaphragm Valve N: Needle Valve P: Panel Mount
R53SH (316L body and Hastelloy® trim)								

